

FSL

Liquid Separator Vacuum Filters



We particularly recommend using the FSL series liquid separator vacuum filters to retain liquid and particles that may be found in a vacuum network. The filtering element consists of a 60 or 100 micron stainless steel filter and protects the vacuum generator under normal operating conditions.

Advantages

- Transparent tank that makes clogging visible.
- Manual drain in the bottom of the tank used to remove any liquid and dirt (Note: This operation must only be carried out when the vacuum network is at atmospheric pressure).

Characteristics

Models	Fitting	Stainless steel filtering	Flow rate ⁽¹⁾ (SCFM)
FSL38 I 100	G3/8"-F	100 µ	12.25
FSL38 I 60	G3/8"-F	60 µ	12.25

(1) The flow rate may vary according to the viscosity of the liquid drawn in.

Specifications

Material	Lid: molded aluminium Tank: transparent polyamide Filter cartridge: stainless steel Accessories: brass and nickel-plated brass Seal: nitrile
Filtering	Two options available: 60 and 100 microns
Operating range	-1 to 2 bar
Pressure max.	2 bar
Temperature	32 to 122°F

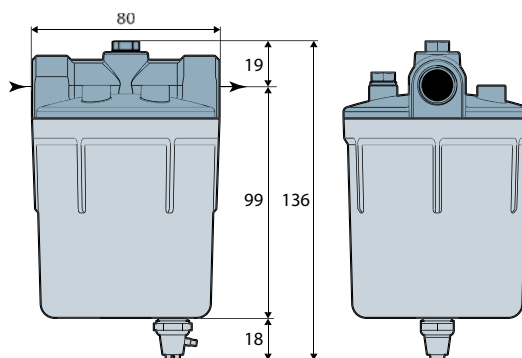

For all orders, please specify:
Model + Filtering
e.g.: FSL38I100

1 : Model	2 : Filtering
FSL38 I	100 100 µ
	60 60 µ



To order a replacement filtering element, please specify:
e.g.: FSL38 I 100 E

Model	Reference of the filtering element	Filtering
FSL38 I 100	FSL38 I 100 E	100 µ
FSL38 I 60	FSL38 I 60 E	60 µ

Mounting bracket for FSL series liquid separator filter

Material: zinc-plated steel

Model

FSL38FIX Mounting bracket for FSL filter

Note: Supplied with two M6 screws to mount bracket on filter.

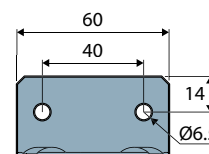
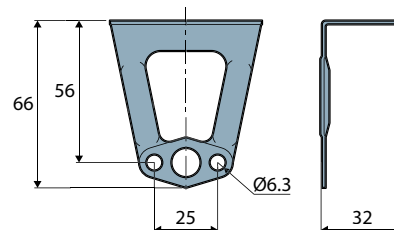

Note: all dimensions are shown in (mm)



Specify part n°: FSL38FIX