

FVL 12

In-line Filter



The FVL12 in-line filter allows quick integration for vacuum pumps GVP and GEMP.

Specifications

Material	Body: Nickel-plated brass Grille: 400 micron stainless steel
Weight	50 g

Mounting on option

The FVL 12 series in-line filter can also be mounted as a GVO P option on GVP series vacuum pumps. See page 7/7.

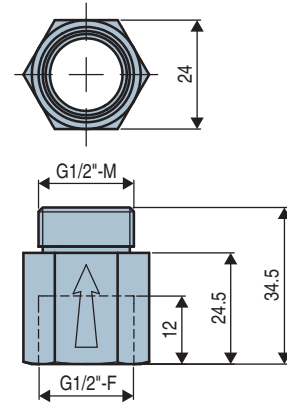

Note: all dimensions are shown in (mm)



For all orders, please specify: FVL12

FVL 68

In-line Vacuum Filter



The FVL68 in-line filter ensures quick integration into a vacuum network, thanks to its push fitting for 6 x 8 calibre pipes.

Ideal for protecting a vacuum generator from normal clogging. The FVL is equipped with a 400 micron filtering grille.

Applications

The FVL68 in-line filter is ideal for protecting LEM mini vacuum pumps. Installation directly onto the vacuum outlet of the pump, using a 6 x 8 push fitting.

Industry-specific applications

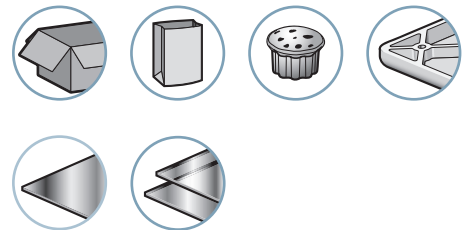

Specifications

Material	Body: POM Grille: 400 micron stainless steel Push fitting Brass – Steel and polymer
Weight	7 g.

Note: all dimensions are shown in (mm)



For all orders, please specify: FVL68

Dimensions

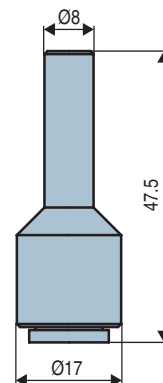

Example usage

