

PSE 100 E

Electric Vacuum Switch



The PSE 100 E series vacuum switch with electric output allows the vacuum level in the system to be checked by means of a patented system.

- It is adapted to all electrical automated systems.
- The choice between the NO or NC function is made during wiring.

Industry-specific applications

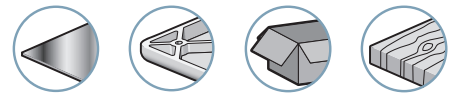

Specifications

Models	Two versions: PSE 100 E and PSE 100 EC
Compatible fluids	All non-corrosive gases
Switching power	250 V - 5 A with cable 250 V - 3 A with M12 connector
Electrical connection	M12 female connector or 3 wire PVC cable, length 2 m
Adjustment range	-400 mb to -800 mb
Precision	3%
Hysteresis	125 mb
Repetitivity	< 3% of the whole range
Maximum speed	30 cycles per minute
Permissible overpressure	2 bar (destructive at 5 bar)
Mechanical endurance	5 x 10 ⁶ operations
Materials	Body: Polyacetal - Vacuum sensor: nitrile membrane
Protection	IP 54 with hollow shaft connected - IP 40 without this fitting
Weight	PSE 100 E: 165 g and PSE 100 EC: 37 g
Temperature	14 °F to 176 °F

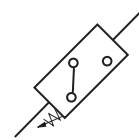

Electrical Connection

M12 connector

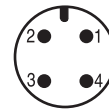

- 1 : Common
- 2 : NO Contact
- 3 : -
- 4 : NC Contact

PVC cable (length 2m)

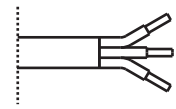

- Brown: Common
- White: NO Contact
- Black: NC Contact

Connection for EC version (M12)

Straight PVC cable, 2 meters: Part No CD M12.
Elbow PVC cable, 2 meters: Part No CC M12.
See page 10/11.

Dimensions

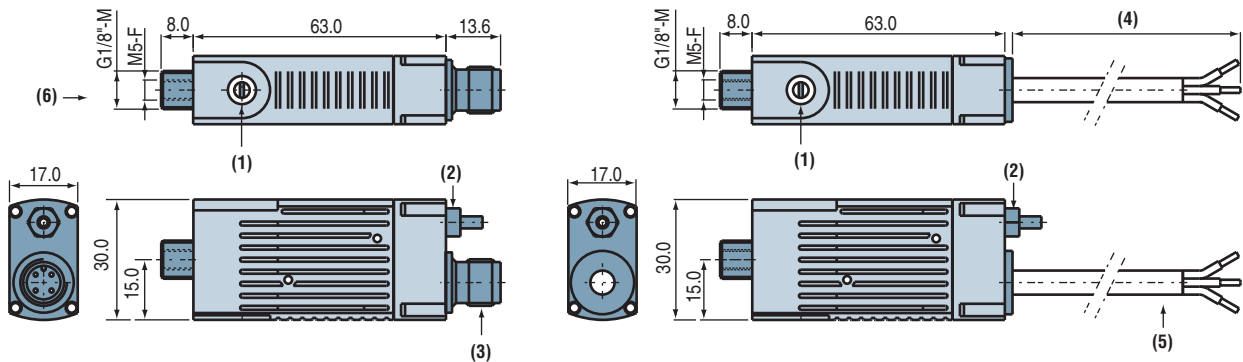

- (1) Adjustment screw
- (2) Atmospheric pressure hollow shaft fitting for tube, inside Ø 2.7mm
- (3) M12 male connector
- (4) Approx. 2 meters
- (5) Cable, 3 conductors
- (6) Vacuum

Additional Information

Vacuum switch attachment - Clip Part No: PSE.F

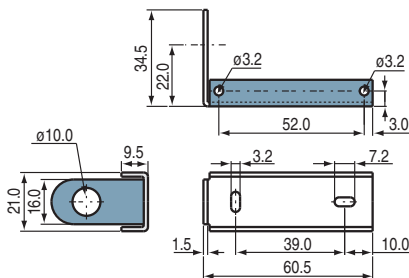

Note: all dimensions shown in (mm)

**For all orders, please specify:
Model + Version.
Example: PSE100EC**

1: Model	2: Version
PSE 100 E	- PVC cable, length 2m
C	M12 connector