

VP

Ventosas planas de Ø 8 a 75 mm

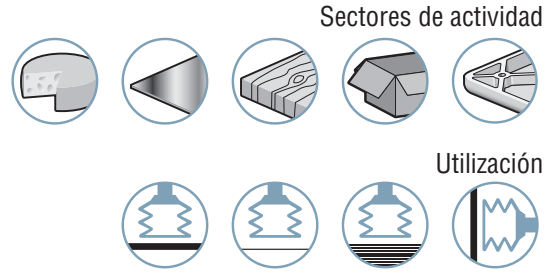

- Las ventosas planas serie VP están altamente recomendadas para la manipulación de productos planos, rígidos y lisos.
- Gran fuerza de tracción.
- Gran resistencia a los esfuerzos laterales permitiendo una manipulación vertical.
- Gran precisión.



2
VP

Materiales

NBR Nitrilo

NR Caucho natural

SIT5 Silicona translúcida

STN SITON®

Características Ventosas

	Ø (mm)	(cm ³)	(N) ⁽¹⁾	(N) ⁽¹⁾	R _{min} (mm)	NBR	SIT5	NR	STN
VP 8	7.5	0.04	1.1	0.5	10	VP8NBR	VP8SIT5	-	VP8STN
VP 10	10	0.05	1.6	0.8	13	VP10NBR	VP10SIT5	-	-
VP 15	15	0.18	3.7	1.8	13	VP15NBR	VP15SIT5	-	VP15STN
VP 20	20	0.44	6.1	3.0	20	VP20NBR	VP20SIT5	-	VP20STN
VP 25	25	0.7	9.4	4.7	25	VP25NBR	VP25SIT5	-	VP25STN
VP 26	26	1.5	11.2	5.6	35	VP26NBR	VP26SIT5	-	-
VP 30	30	2.9	15.9	7.9	40	VP30NBR	VP30SIT5	-	VP30STN
VP 35	35	2.7	23.1	11.6	50	VP35NBR	VP35SIT5	-	-
VP 40	40	4	26.7	13.4	50	VP40NBR	VP40SIT5	VP40NR	VP40STN
VP 50	52	7	38.3	19.1	75	VP50NBR	VP50SIT5	-	VP50STN
VP 60	60	7.3	57.8	28.9	100	VP60NBR	VP60SIT5	-	-
VP 75	75	16	101.1	50.6	130	VP75NBR	VP75SIT5	VP75NR	-

(1) Fuerza práctica de la ventosa con un vacío del 65 % y un coeficiente de seguridad incluido de 2 para manipulación horizontal y de 4 para manipulación vertical.

Selección de los insertos

(Ø)	Grupo	M5-M	M6-M	M8-M	M10-M	G1/8"-F	G1/8"-M	10/32-M	G1/4"-F	G1/4"-M	G3/8"-M	G1/2"-M
8...25	1	■	■	-	-	■	■	□	-	-	-	-
26...60	2	□	□	□	□	■	■	-	■	■	-	-
75	3	-	-	-	□	-	■	-	■	■	■	□

■ Combinaciones «ventosa + inserto» disponibles
Ver referencias página 2/4

□ Soluciones de montaje adicionales
Ver página 2/7

Fijación: M = Macho F = Hembra

Esquemas de montaje

Las ventosas COVAL disponen de una gran modularidad de montaje.



Versión C: Inserto cánula



Versión S: Inserto remachado de fábrica



Versión V: Inserto desmontable
(insertos interiores y adaptadores)

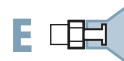

Versión E: Inserto embutido



Indique la referencia ej.: VP40STNIM14C
Diríjase a la página 2/4

Accesorios

Con el fin de optimizar la utilización de sus ventosas, Coval ofrece toda una gama de accesorios (insertos de toberas, sistemas resorte, alargadores, nodrizas, etc.), véanse capítulos 4 y 14.



Grupo 1



Ventosa	M5-M	M6-M	G1/8"-M	G1/8"-F
VP8NBR	VP8NBRIMM5C	VP8NBRIMM6C	VP8NBRIM18C	VP8NBRIF18C
VP8SIT5	VP8SIT5IMM5C	VP8SIT5IMM6C	VP8SIT5IM18C	VP8SIT5IF18C
VP8STN	VP8STNIMM5C	VP8STNIMM6C	VP8STNIM18C	VP8STNIF18C
VP10NBR	VP10NBRIMM5C	VP10NBRIMM6C	VP10NBRIM18C	VP10NBRIF18C
VP10SIT5	VP10SIT5IMM5C	VP10SIT5IMM6C	VP10SIT5IM18C	VP10SIT5IF18C
VP15NBR	VP15NBRIMM5C	VP15NBRIMM6C	VP15NBRIM18C	VP15NBRIF18C
VP15SIT5	VP15SIT5IMM5C	VP15SIT5IMM6C	VP15SIT5IM18C	VP15SIT5IF18C
VP15STN	VP15STNIMM5C	VP15STNIMM6C	VP15STNIM18C	VP15STNIF18C
VP20NBR	VP20NBRIMM5C	VP20NBRIMM6C	VP20NBRIM18C	VP20NBRIF18C
VP20SIT5	VP20SIT5IMM5C	VP20SIT5IMM6C	VP20SIT5IM18C	VP20SIT5IF18C
VP20STN	VP20STNIMM5C	VP20STNIMM6C	VP20STNIM18C	VP20STNIF18C
VP25NBR	VP25NBRIMM5C	VP25NBRIMM6C	VP25NBRIM18C	VP25NBRIF18C
VP25SIT5	VP25SIT5IMM5C	VP25SIT5IMM6C	VP25SIT5IM18C	VP25SIT5IF18C
VP25STN	VP25STNIMM5C	VP25STNIMM6C	VP25STNIM18C	VP25STNIF18C

Grupo 2



Ventosa	G1/4"-M	G1/4"-F	G1/4"-M	G1/4"-F	G1/8"-M	G1/8"-F	G1/4"-M	G1/4"-F
VP26NBR	VP26NBRIM14C	VP26NBRIF14C	VP26NBRIM14	VP26NBRIF14	VP26NBRIM18V	VP26NBRIF18V	VP26NBRIM14V	VP26NBRIF14V
VP26SIT5	VP26SIT5IM14C	VP26SIT5IF14C	VP26SIT5IM14	VP26SIT5IF14	VP26SIT5IM18V	VP26SIT5IF18V	VP26SIT5IM14V	VP26SIT5IF14V
VP30NBR	VP30NBRIM14C	VP30NBRIF14C	VP30NBRIM14	VP30NBRIF14	VP30NBRIM18V	VP30NBRIF18V	VP30NBRIM14V	VP30NBRIF14V
VP30SIT5	VP30SIT5IM14C	VP30SIT5IF14C	VP30SIT5IM14	VP30SIT5IF14	VP30SIT5IM18V	VP30SIT5IF18V	VP30SIT5IM14V	VP30SIT5IF14V
VP30STN	VP30STNIM14C	VP30STNIF14C	VP30STNIM14	VP30STNIF14	VP30STNIM18V	VP30STNIF18V	VP30STNIM14V	VP30STNIF14V
VP35NBR	VP35NBRIM14C	VP35NBRIF14C	VP35NBRIM14	VP35NBRIF14	VP35NBRIM18V	VP35NBRIF18V	VP35NBRIM14V	VP35NBRIF14V
VP35SIT5	VP35SIT5IM14C	VP35SIT5IF14C	VP35SIT5IM14	VP35SIT5IF14	VP35SIT5IM18V	VP35SIT5IF18V	VP35SIT5IM14V	VP35SIT5IF14V
VP40NBR	VP40NBRIM14C	VP40NBRIF14C	VP40NBRIM14	VP40NBRIF14	VP40NBRIM18V	VP40NBRIF18V	VP40NBRIM14V	VP40NBRIF14V
VP40NR	VP40NRIM14C	VP40NRIF14C	VP40NRIM14	VP40NRIF14	VP40NRIM18V	VP40NRIF18V	VP40NRIM14V	VP40NRIF14V
VP40SIT5	VP40SIT5IM14C	VP40SIT5IF14C	VP40SIT5IM14	VP40SIT5IF14	VP40SIT5IM18V	VP40SIT5IF18V	VP40SIT5IM14V	VP40SIT5IF14V
VP40STN	VP40STNIM14C	VP40STNIF14C	VP40STNIM14	VP40STNIF14	VP40STNIM18V	VP40STNIF18V	VP40STNIM14V	VP40STNIF14V
VP50NBR	VP50NBRIM14C	VP50NBRIF14C	VP50NBRIM14	VP50NBRIF14	VP50NBRIM18V	VP50NBRIF18V	VP50NBRIM14V	VP50NBRIF14V
VP50SIT5	VP50SIT5IM14C	VP50SIT5IF14C	VP50SIT5IM14	VP50SIT5IF14	VP50SIT5IM18V	VP50SIT5IF18V	VP50SIT5IM14V	VP50SIT5IF14V
VP50STN	VP50STNIM14C	VP50STNIF14C	VP50STNIM14	VP50STNIF14	VP50STNIM18V	VP50STNIF18V	VP50STNIM14V	VP50STNIF14V
VP60NBR	VP60NBRIM14C	VP60NBRIF14C	VP60NBRIM14	VP60NBRIF14	VP60NBRIM18V	VP60NBRIF18V	VP60NBRIM14V	VP60NBRIF14V
VP60SIT5	VP60SIT5IM14C	VP60SIT5IF14C	VP60SIT5IM14	VP60SIT5IF14	VP60SIT5IM18V	VP60SIT5IF18V	VP60SIT5IM14V	VP60SIT5IF14V

Grupo 3



Ventosa	G1/8"-M	G1/4"-M	G1/4"-F	G1/4"-M	G1/4"-F	G3/8"-M
VP75NBR	VP75NBRIM18V	VP75NBRIM14V	VP75NBRIF14V	VP75NBRIM14	VP75NBRIF14	VP75NBRIM38
VP75NR	VP75NRIM18V	VP75NRIM14V	VP75NRIF14V	VP75NRIM14	VP75NRIF14	VP75NRIM38
VP75SIT5	VP75SIT5IM18V	VP75SIT5IM14V	VP75SIT5IF14V	VP75SIT5IM14	VP75SIT5IF14	VP75SIT5IM38

M = Macho F = Hembra

Las soluciones de montaje adicionales son disponibles (ver página 2/7).
Las combinaciones « ventosa + inserto » versión C y V son entregadas sin montar.

VP

Ventosas planas de Ø 8 a 75 mm

Dimensiones « ventosa + inserto »



2
VP

VP 8 - 10 Grupo 1

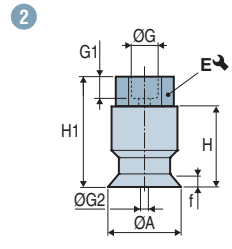
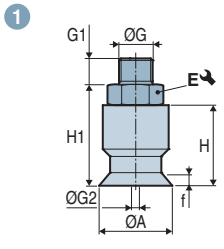

VP 15 - 25 Grupo 1

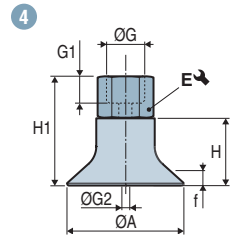
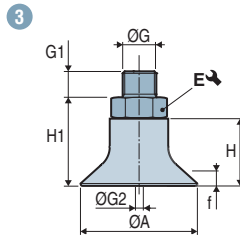

VP 26 - 60 Grupo 2

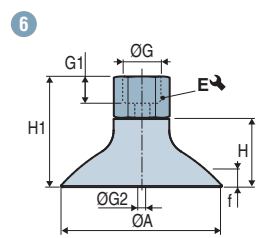
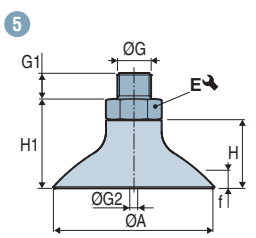

VP 75 Grupo 3

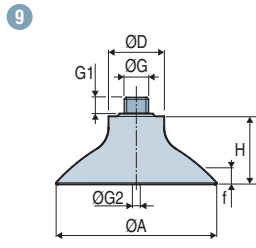
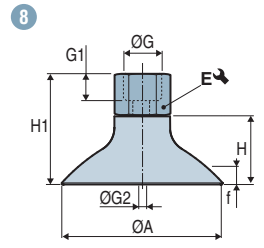
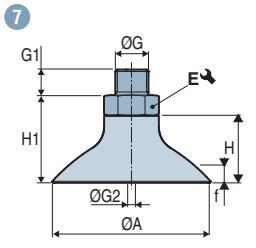

Grupo 1	Diagrama	ØA	ØD	f ⁽¹⁾	H	H1	ØG	G1	ØG2 ⁽²⁾	E ↘	⊖ (g)	
Ø 8 - 25 mm	VP8---IMM5C	1	7.5	-	1.3	10	15	M5-M	4.5	2.5	7	3.5
	VP8---IMM6C	1	7.5	-	1.3	10	15	M6-M	5	3.5	7	3.1
	VP8---IM18C	1	7.5	-	1.3	10	16	G1/8"-M	7.5	3.5	14	4.5
	VP8---IF18C	2	7.5	-	1.3	10	22	G1/8"-F	8	3.5	14	4.4
	VP10---IMM5C	1	10	-	1.5	10.5	15.5	M5-M	4.5	2.5	7	3.6
	VP10---IMM6C	1	10	-	1.5	10.5	15.5	M6-M	5	3.5	7	3.2
	VP10---IM18C	1	10	-	1.5	10.5	16.5	G1/8"-M	7.5	3.5	14	4.6
	VP10---IF18C	2	10	-	1.5	10.5	22.5	G1/8"-F	8	3.5	14	4.5
	VP15---IMM5C	3	15	-	2.25	11	16	M5-M	4.5	2.5	7	3.8
	VP15---IMM6C	3	15	-	2.25	11	16	M6-M	5	3.5	7	3.4
	VP15---IM18C	3	15	-	2.25	11	17	G1/8"-M	7.5	3.5	14	4.8
	VP15---IF18C	4	15	-	2.25	11	23	G1/8"-F	8	3.5	14	4.7
	VP20---IMM5C	3	20	-	3	11.5	16.5	M5-M	4.5	2.5	7	4.2
	VP20---IMM6C	3	20	-	3	11.5	16.5	M6-M	5	3.5	7	3.8
	VP20---IM18C	3	20	-	3	11.5	17.5	G1/8"-M	7.5	3.5	14	5.2
	VP20---IF18C	4	20	-	3	11.5	23.5	G1/8"-F	8	3.5	14	5.1
	VP25---IMM5C	3	25	-	3	12	17	M5-M	4.5	2.5	7	4.6
	VP25---IMM6C	3	25	-	3	12	17	M6-M	5	3.5	7	4.2
	VP25---IM18C	3	25	-	3	12	18	G1/8"-M	7.5	3.5	14	5.6
	VP25---IF18C	4	25	-	3	12	24	G1/8"-F	8	3.5	14	5.5

Nota: Todas las cotas están indicadas en mm

(1) f = Flecha de la ventosa.

(2) Ø de paso interno del inserto. = Ø de paso interno del inserto.



Grupo 2	Diagrama	ØA	ØD	f ⁽¹⁾	H	H1	ØG	G1	ØG2 ⁽²⁾	E ↻	 (g)	
Ø 26 - 60 mm	VP26---IM18V	5	26	-	3	19.5	24	G1/8"-M	6	3.5	13	17.9
	VP26---IF18V	6	26	-	3	19.5	32.5	G1/8"-F	7.5	3.5	13	21.2
	VP26---IM14	5	26	-	3	19.5	23.5	G1/4"-M	11	4.4	17	11.6
	VP26---IM14C	5	26	-	3	19.5	27.5	G1/4"-M	10	7	17	12.5
	VP26---IM14V	5	26	-	3	19.5	24.5	G1/4"-M	8	3.5	17	27.2
	VP26---IF14	6	26	-	3	19.5	34.5	G1/4"-F	10	4.4	17	12.2
	VP26---IF14C	6	26	-	3	19.5	34.5	G1/4"-F	12	6.9	17	11.8
	VP26---IF14V	6	26	-	3	19.5	35.5	G1/4"-F	11	3.5	17	31.8
	VP30---IM18V	5	30	-	2.5	19	23.5	G1/8"-M	6	3.5	13	17.3
	VP30---IF18V	6	30	-	2.5	19	32	G1/8"-F	7.5	3.5	13	21.6
	VP30---IM14	5	30	-	2.5	19	23	G1/4"-M	11	4.4	17	12.0
	VP30---IM14C	5	30	-	2.5	19	27	G1/4"-M	10	7	17	12.9
	VP30---IM14V	5	30	-	2.5	19	24	G1/4"-M	8	3.5	17	27.6
	VP30---IF14	6	30	-	2.5	19	34	G1/4"-F	10	4.4	17	12.6
	VP30---IF14C	6	30	-	2.5	19	34	G1/4"-F	12	6.9	17	12.2
	VP30---IF14V	6	30	-	2.5	19	35	G1/4"-F	11	3.5	17	32.2
	VP35---IM18V	5	35	-	3	20	24.5	G1/8"-M	6	3.5	13	20.1
	VP35---IF18V	6	35	-	3	20	33	G1/8"-F	7.5	3.5	13	23.4
	VP35---IM14	5	35	-	3	20	24	G1/4"-M	11	4.4	17	13.8
	VP35---IM14C	5	35	-	3	20	28	G1/4"-M	10	7	17	14.7
	VP35---IM14V	5	35	-	3	20	25	G1/4"-M	8	3.5	17	29.4
	VP35---IF14	6	35	-	3	20	35	G1/4"-F	10	4.4	17	14.4
	VP35---IF14C	6	35	-	3	20	35	G1/4"-F	12	6.9	17	14.0
	VP35---IF14V	6	35	-	3	20	36	G1/4"-F	11	3.5	17	34.0
	VP40---IM18V	5	40	-	3	20	24.5	G1/8"-M	6	3.5	13	20.6
	VP40---IF18V	6	40	-	3	20	33	G1/8"-F	7.5	3.5	13	23.9
	VP40---IM14	5	40	-	3	20	24	G1/4"-M	11	4.4	17	14.3
	VP40---IM14C	5	40	-	3	20	28	G1/4"-M	10	7	17	15.2
	VP40---IM14V	5	40	-	3	20	25	G1/4"-M	8	3.5	17	29.9
	VP40---IF14	6	40	-	3	20	35	G1/4"-F	10	4.4	17	14.9
VP40---IF14C	6	40	-	3	20	35	G1/4"-F	12	6.9	17	14.5	
VP40---IF14V	6	40	-	3	20	36	G1/4"-F	11	3.5	17	34.5	
VP50---IM18V	5	52	-	4.5	22	26.5	G1/8"-M	6	3.5	13	26.4	
VP50---IF18V	6	52	-	4.5	22	35	G1/8"-F	7.5	3.5	13	29.7	
VP50---IM14	5	52	-	4.5	22	26	G1/4"-M	11	4.4	17	20.1	
VP50---IM14C	5	52	-	4.5	22	30	G1/4"-M	10	7	17	21.0	
VP50---IM14V	5	52	-	4.5	22	27	G1/4"-M	8	3.5	17	35.7	
VP50---IF14	6	52	-	4.5	22	37	G1/4"-F	10	4.4	17	20.7	
VP50---IF14C	6	52	-	4.5	22	37	G1/4"-F	12	6.9	17	20.3	
VP50---IF14V	6	52	-	4.5	22	38	G1/4"-F	11	3.5	17	40.3	
VP60---IM18V	5	60	-	4.5	22	26.5	G1/8"-M	6	3.5	13	30.1	
VP60---IF18V	6	60	-	4.5	22	35	G1/8"-F	7.5	3.5	13	33.4	
VP60---IM14	5	60	-	4.5	22	26	G1/4"-M	11	4.4	17	23.8	
VP60---IM14C	5	60	-	4.5	22	30	G1/4"-M	10	7	17	24.7	
VP60---IM14V	5	60	-	4.5	22	27	G1/4"-M	8	3.5	17	39.4	
VP60---IF14	6	60	-	4.5	22	37	G1/4"-F	10	4.4	17	24.4	
VP60---IF14C	6	60	-	4.5	22	37	G1/4"-F	12	6.9	17	24.0	
VP60---IF14V	6	60	-	4.5	22	38	G1/4"-F	11	3.5	17	44.0	

Grupo 3

Ø 75 mm	VP75---IM18V	9	75	23	4.5	32	-	G1/8"-M	8	6	-	58.3
	VP75---IM14	7	75	-	4.5	32	38	G1/4"-M	11	8	21	46.4
	VP75---IM14V	7	75	-	4.5	32	37	G1/4"-M	8	6	17	68.9
	VP75---IF14	8	75	-	4.5	32	47	G1/4"-F	10	8	21	50.3
	VP75---IF14V	8	75	-	4.5	32	51	G1/4"-F	9	6	17	78.5
	VP75---IM38	7	75	-	4.5	32	43	G3/8"-M	11	8	21	47

Nota: Todas las cotas están indicadas en mm

(1) f = Flecha de la ventosa.

(2) Ø G2 = Ø de paso interno del inserto.



VP 8 - 25 Grupo 1

Insertos cánulas **C**

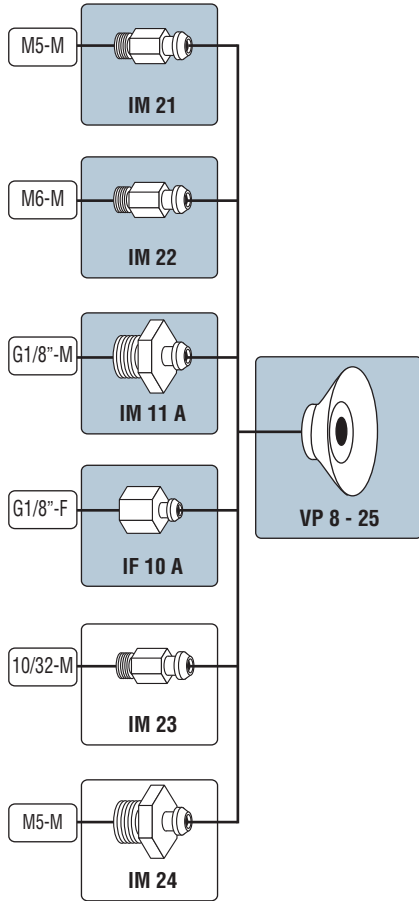

VP 26 - 60 Grupo 2

Insertos cánulas **C**

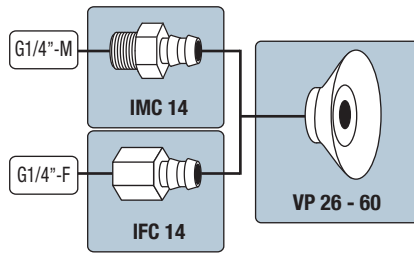

Insertos embutidos **E**

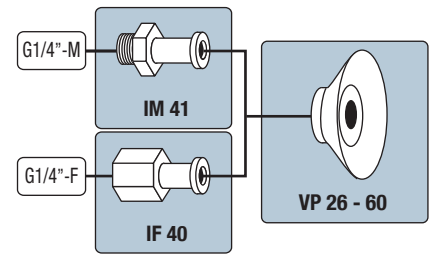

Adaptadores

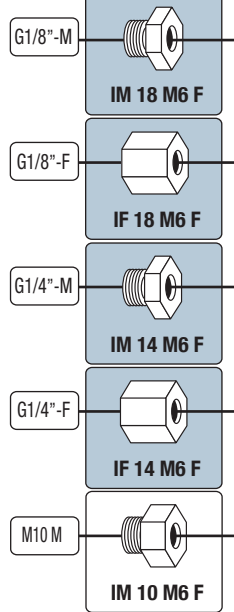

Insertos desmontables **V**

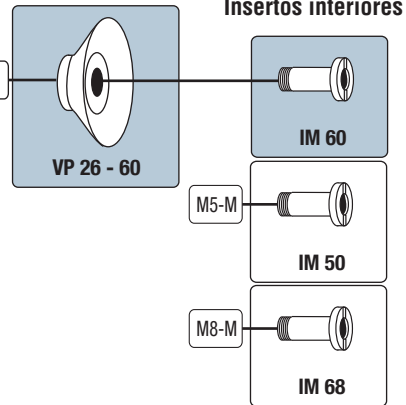

VP 75 Grupo 3

Insertos remachados de fábrica **S**

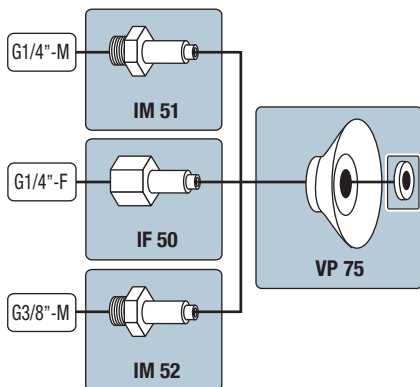

Insertos desmontables **V**

adaptadores

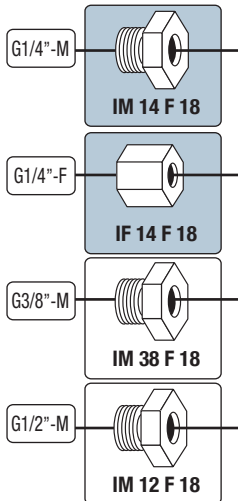

Insertos interiores

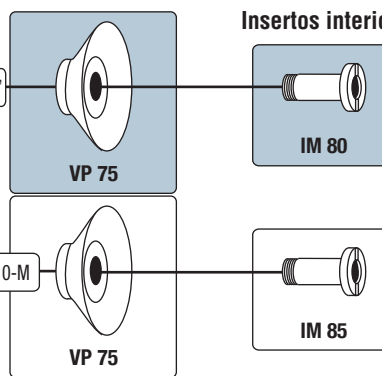

- Combinaciones «ventosa + inserto» referencias página 2/4
- Solución de montaje opcionales, pedir en referencias separadas

Cotas de dimensiones de los insertos: véanse página 2/8.



Ventosas

VP 8... 10

VP 15... 25

VP 26... 75

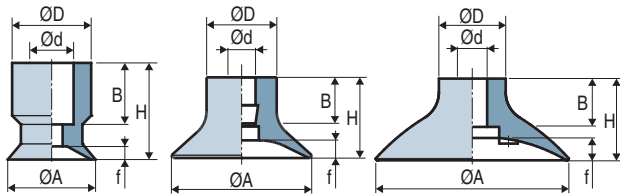

(1) f = Flecha de la ventosa.

	ØA	H	Ød	ØD	f (1)	B	(g)
VP 8	7.5	10	5	9	1.3	7	0.4
VP 10	10	10.5	4.4	9	1.5	7	0.5
VP 15	15	11	4	9	2.25	7	0.7
VP 20	20	11.5	4	10	3	7	1.2
VP 25	25	12	4	10	3	7	1.4
VP 26	26	19.5	8	16	3	13	3.7
VP 30	30	19	8	16	2.5	13	4
VP 35	35	20	8	16	3	13	5.6
VP 40	40	20	8	16	3	13	9
VP 50	52	22	8	18	4.5	13	14
VP 60	60	22	8	18	4.5	13	16
VP 75	75	32	12	23	4.5	20	33

Insertos cánulas

Macho - IM

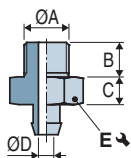

Hembra - IF

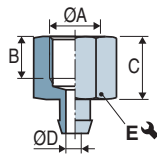

	ØA	B	C	ØD	E	Materiales	(g)
IM 11 A	G1/8"-M	7.5	6	3.5	14	Aluminio	4.1
IMC 14	G1/4"-M	10	8	7	17	Aluminio	8.7
IM 21 (2)	M5-M	4.5	5	2.5	7	Latón niquelado	3.1
IM 22 (2)	M6-M	5	5	3.5	7	Latón niquelado	2.7
IM 23	10/32-M	4.5	5	2.5	7	Latón niquelado	3
IM 24	M5-M	4.5	2.5	2.5	10	Latón niquelado	3.2
IF 10 A	G1/8"-F	8	12	3.5	14	Aluminio	4
IFC 14	G1/4"-F	12	15	6.9	17	Aluminio	8

Insertos interiores

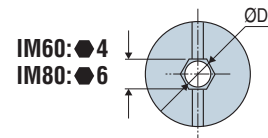
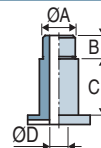

	ØA	B	C	ØD	Materiales	(g)
IM 50	M5-M	5	11	2.8	Latón	7.4
IM 60 (2) (3)	M6-M	7	11	3.5	Latón niquelado	7.5
IM 68	M8-M	8	11	5.2	Latón niquelado	6.4
IM 80	G1/8"-M	8	18	6	Latón niquelado	23.7
IM 85	M10x150-M	8	18	6	Latón niquelado	23.5

Insertos remachados de fábrica

Macho - IM

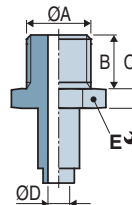

Hembra - IF

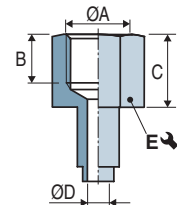

	ØA	B	C	ØD	E	Materiales	(g)
IM 51	G1/4"-M	11	6	4.4	17	Aluminio	11.8
IF 50	G1/4"-F	10	15	8	21	Aluminio	15.7
IM 52	G3/8"-M	11	6	8	21	Aluminio	14

Adaptadores para insertos interiores

Macho - IM

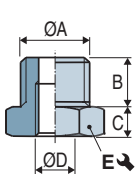

Hembra - IF

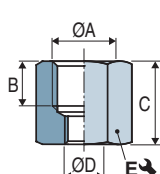

	ØA	B	C	ØD	E	Materiales	(g)
IM 10 M6F	M10-M	7	3.5	M6-F	13	Latón	5.9
IM 12 F18	G1/2"-M	14	6	G1/8"-F	22	Latón niquelado	46.8
IM 14 M6F	G1/4"-M	8	5	M6-F	17	Latón niquelado	15.9
IM 14 F18	G1/4"-M	8	5	G1/8"-F	17	Latón niquelado	10.6
IM 18 M6F	G1/8"-M	6	4.5	M6-F	13	Latón niquelado	6.6
IM 38 F18	G3/8"-M	9	5	G1/8"-F	19	Latón niquelado	18.8
IF 14 M6F	G1/4"-F	11	16	M6-F	17	Latón niquelado	20.5
IF 18 M6F	G1/8"-F	7.5	13	M6-F	13	Latón niquelado	9.9
IF 14 F18	G1/4"-F	9	19	G1/8"-F	17	Latón niquelado	20.2

Los valores son representativos de las características medias de nuestros productos.

Nota: Todas las cotas están indicadas en mm.

(2) Versión Insertos de toberas: diámetro calibrado para disminuir los escapes en caso de utilizar un cajón multiventosas (véase página 4/10).

(3) Disponible en acero inoxidable.

Insertos embudidos

Macho - IM

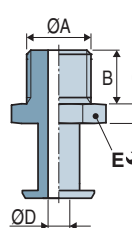

Hembra - IF

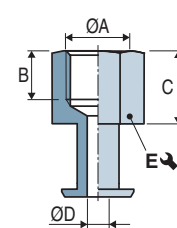

	ØA	B	C	ØD	E	Materiales	(g)
IM 41	G1/4"-M	11	4	4.4	17	Aluminio	7.8
IF 40	G1/4"-F	10	15	4.4	17	Aluminio	8.4