

# VP

## Ventose a coppa Ø da 8 a 75 mm



Le ventose della serie VP sono particolarmente indicate per la manipolazione di prodotti piani, rigidi e lisci.

- Elevata forza di sollevamento.
- Grande resistenza agli sforzi laterali che consente la manipolazione a taglio.
- Grande precisione.

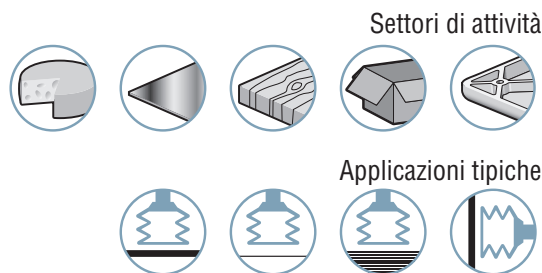

2  
VP

### Materiali

<b>NBR</b>	Nitrile	<b>SIT5</b>	Silicone Traslucento
<b>NR</b>	Caucciù naturale	<b>STN</b>	SITON®

### Caratteristiche delle ventose

	Ø (mm)	(cm <sup>3</sup> )	(N) <sup>(1)</sup>	(N) <sup>(1)</sup>	R <sub>min</sub> (mm)	NBR	SIT5	NR	STN
VP 8	7.5	0.04	1.1	0.5	10	VP8NBR	VP8SIT5	-	VP8STN
VP 10	10	0.05	1.6	0.8	13	VP10NBR	VP10SIT5	-	-
VP 15	15	0.18	3.7	1.8	13	VP15NBR	VP15SIT5	-	VP15STN
VP 20	20	0.44	6.1	3.0	20	VP20NBR	VP20SIT5	-	VP20STN
VP 25	25	0.7	9.4	4.7	25	VP25NBR	VP25SIT5	-	VP25STN
VP 26	26	1.5	11.2	5.6	35	VP26NBR	VP26SIT5	-	-
VP 30	30	2.9	15.9	7.9	40	VP30NBR	VP30SIT5	-	VP30STN
VP 35	35	2.7	23.1	11.6	50	VP35NBR	VP35SIT5	-	-
VP 40	40	4	26.7	13.4	50	VP40NBR	VP40SIT5	VP40NR	VP40STN
VP 50	52	7	38.3	19.1	75	VP50NBR	VP50SIT5	-	VP50STN
VP 60	60	7.3	57.8	28.9	100	VP60NBR	VP60SIT5	-	-
VP 75	75	16	101.1	50.6	130	VP75NBR	VP75SIT5	VP75NR	-

(1) Forza pratica della ventosa con un vuoto pari al 65% ed un coefficiente di sicurezza 2 per manipolazione orizzontale e coefficiente 4 per manipolazione verticale.

### Sceita degli inserti

(Ø)	Gruppo	M5-M	M6-M	M8-M	M10-M	G1/8"-F	G1/8"-M	10/32-M	G1/4"-F	G1/4"-M	G3/8"-M	G1/2"-M
8...25	1	■	■	-	-	■	■	□	-	-	-	-
26...60	2	□	□	□	□	■	■	-	■	■	-	-
75	3	-	-	-	□	-	■	-	■	■	■	□

■ Configurazioni «ventosa+inserto» disponibili  
Vedi rif. Pag. 2/4

□ Soluzioni di montaggio aggiuntive  
Vedere pagina 2/7

Fissaggio: M = maschio

F = femmina

### Tipi di montaggio

Le ventose COVAL dispongono di una grande modularità di montaggio:



**Versione C:** Inserto a resca



**Versione S:** Inserto rivettato in fabbrica



**Versione V:** Inserto smontabile (adattatore e vite scanalata)



**Versione E:** Inserto montato in fabbrica



Specificare codice es: **VP40STNIM14C**  
Rif. pag. 2/4

### Accessori

Per ottimizzare l'utilizzo delle ventose, Coval propone una gamma completa di accessori (inserti con foro calibrato, compensatori di livello, prolunghie, serbatoi, ecc.), vedere capitoli 4 e 14.



#### Gruppo 1



FILETTATURA	M5-M	M6-M	G1/8"-M	G1/8"-F
<b>VP8NBR</b>	VP8NBRIMM5C	VP8NBRIMM6C	VP8NBRIM18C	VP8NBRIF18C
<b>VP8SIT5</b>	VP8SIT5IMM5C	VP8SIT5IMM6C	VP8SIT5IM18C	VP8SIT5IF18C
<b>VP8STN</b>	VP8STNIMM5C	VP8STNIMM6C	VP8STNIM18C	VP8STNIF18C
<b>VP10NBR</b>	VP10NBRIMM5C	VP10NBRIMM6C	VP10NBRIM18C	VP10NBRIF18C
<b>VP10SIT5</b>	VP10SIT5IMM5C	VP10SIT5IMM6C	VP10SIT5IM18C	VP10SIT5IF18C
<b>VP15NBR</b>	VP15NBRIMM5C	VP15NBRIMM6C	VP15NBRIM18C	VP15NBRIF18C
<b>VP15SIT5</b>	VP15SIT5IMM5C	VP15SIT5IMM6C	VP15SIT5IM18C	VP15SIT5IF18C
<b>VP15STN</b>	VP15STNIMM5C	VP15STNIMM6C	VP15STNIM18C	VP15STNIF18C
<b>VP20NBR</b>	VP20NBRIMM5C	VP20NBRIMM6C	VP20NBRIM18C	VP20NBRIF18C
<b>VP20SIT5</b>	VP20SIT5IMM5C	VP20SIT5IMM6C	VP20SIT5IM18C	VP20SIT5IF18C
<b>VP20STN</b>	VP20STNIMM5C	VP20STNIMM6C	VP20STNIM18C	VP20STNIF18C
<b>VP25NBR</b>	VP25NBRIMM5C	VP25NBRIMM6C	VP25NBRIM18C	VP25NBRIF18C
<b>VP25SIT5</b>	VP25SIT5IMM5C	VP25SIT5IMM6C	VP25SIT5IM18C	VP25SIT5IF18C
<b>VP25STN</b>	VP25STNIMM5C	VP25STNIMM6C	VP25STNIM18C	VP25STNIF18C

#### Gruppo 2



FILETTATURA	G1/4"-M	G1/4"-F	G1/4"-M	G1/4"-F	G1/8"-M	G1/8"-F	G1/4"-M	G1/4"-F
<b>VP26NBR</b>	VP26NBRIM14C	VP26NBRIF14C	VP26NBRIM14	VP26NBRIF14	VP26NBRIM18V	VP26NBRIF18V	VP26NBRIM14V	VP26NBRIF14V
<b>VP26SIT5</b>	VP26SIT5IM14C	VP26SIT5IF14C	VP26SIT5IM14	VP26SIT5IF14	VP26SIT5IM18V	VP26SIT5IF18V	VP26SIT5IM14V	VP26SIT5IF14V
<b>VP30NBR</b>	VP30NBRIM14C	VP30NBRIF14C	VP30NBRIM14	VP30NBRIF14	VP30NBRIM18V	VP30NBRIF18V	VP30NBRIM14V	VP30NBRIF14V
<b>VP30SIT5</b>	VP30SIT5IM14C	VP30SIT5IF14C	VP30SIT5IM14	VP30SIT5IF14	VP30SIT5IM18V	VP30SIT5IF18V	VP30SIT5IM14V	VP30SIT5IF14V
<b>VP30STN</b>	VP30STNIM14C	VP30STNIF14C	VP30STNIM14	VP30STNIF14	VP30STNIM18V	VP30STNIF18V	VP30STNIM14V	VP30STNIF14V
<b>VP35NBR</b>	VP35NBRIM14C	VP35NBRIF14C	VP35NBRIM14	VP35NBRIF14	VP35NBRIM18V	VP35NBRIF18V	VP35NBRIM14V	VP35NBRIF14V
<b>VP35SIT5</b>	VP35SIT5IM14C	VP35SIT5IF14C	VP35SIT5IM14	VP35SIT5IF14	VP35SIT5IM18V	VP35SIT5IF18V	VP35SIT5IM14V	VP35SIT5IF14V
<b>VP40NBR</b>	VP40NBRIM14C	VP40NBRIF14C	VP40NBRIM14	VP40NBRIF14	VP40NBRIM18V	VP40NBRIF18V	VP40NBRIM14V	VP40NBRIF14V
<b>VP40NR</b>	VP40NRIM14C	VP40NRIF14C	VP40NRIM14	VP40NRIF14	VP40NRIM18V	VP40NRIF18V	VP40NRIM14V	VP40NRIF14V
<b>VP40SIT5</b>	VP40SIT5IM14C	VP40SIT5IF14C	VP40SIT5IM14	VP40SIT5IF14	VP40SIT5IM18V	VP40SIT5IF18V	VP40SIT5IM14V	VP40SIT5IF14V
<b>VP40STN</b>	VP40STNIM14C	VP40STNIF14C	VP40STNIM14	VP40STNIF14	VP40STNIM18V	VP40STNIF18V	VP40STNIM14V	VP40STNIF14V
<b>VP50NBR</b>	VP50NBRIM14C	VP50NBRIF14C	VP50NBRIM14	VP50NBRIF14	VP50NBRIM18V	VP50NBRIF18V	VP50NBRIM14V	VP50NBRIF14V
<b>VP50SIT5</b>	VP50SIT5IM14C	VP50SIT5IF14C	VP50SIT5IM14	VP50SIT5IF14	VP50SIT5IM18V	VP50SIT5IF18V	VP50SIT5IM14V	VP50SIT5IF14V
<b>VP50STN</b>	VP50STNIM14C	VP50STNIF14C	VP50STNIM14	VP50STNIF14	VP50STNIM18V	VP50STNIF18V	VP50STNIM14V	VP50STNIF14V
<b>VP60NBR</b>	VP60NBRIM14C	VP60NBRIF14C	VP60NBRIM14	VP60NBRIF14	VP60NBRIM18V	VP60NBRIF18V	VP60NBRIM14V	VP60NBRIF14V
<b>VP60SIT5</b>	VP60SIT5IM14C	VP60SIT5IF14C	VP60SIT5IM14	VP60SIT5IF14	VP60SIT5IM18V	VP60SIT5IF18V	VP60SIT5IM14V	VP60SIT5IF14V

#### Gruppo 3



FILETTATURA	G1/8"-M	G1/4"-M	G1/4"-F	G1/4"-M	G1/4"-F	G3/8"-M
<b>VP75NBR</b>	VP75NBRIM18V	VP75NBRIM14V	VP75NBRIF14V	VP75NBRIM14	VP75NBRIF14	VP75NBRIM38
<b>VP75NR</b>	VP75NRIM18V	VP75NRIM14V	VP75NRIF14V	VP75NRIM14	VP75NRIF14	VP75NRIM38
<b>VP75SIT5</b>	VP75SIT5IM18V	VP75SIT5IM14V	VP75SIT5IF14V	VP75SIT5IM14	VP75SIT5IF14	VP75SIT5IM38

Sono disponibili soluzioni di montaggio aggiuntive (vedere pagina 2/7).  
Le configurazioni « ventosa + inserto » della versione C e V sono consegnate smontate.

# VP

## Ventose a coppa Ø da 8 a 75 mm

Dimensioni « ventosa + inserto »



2  
VP

### VP 8 - 10 Gruppo 1

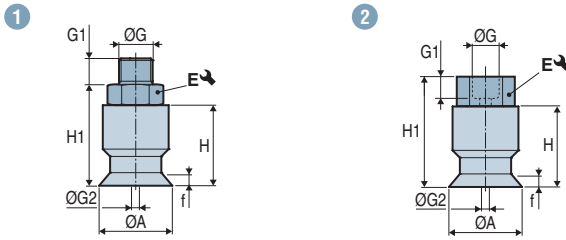

### VP 15 - 25 Gruppo 1

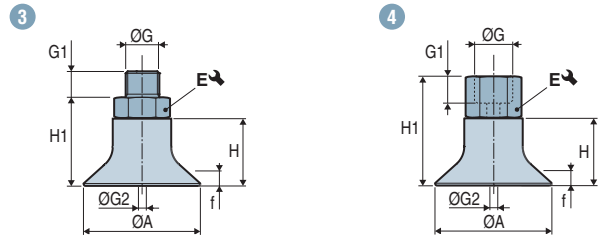

### VP 26 - 60 Gruppo 2

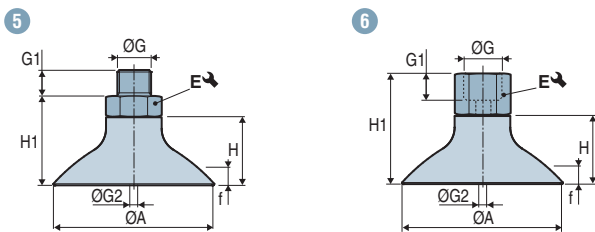

### VP 75 Gruppo 3

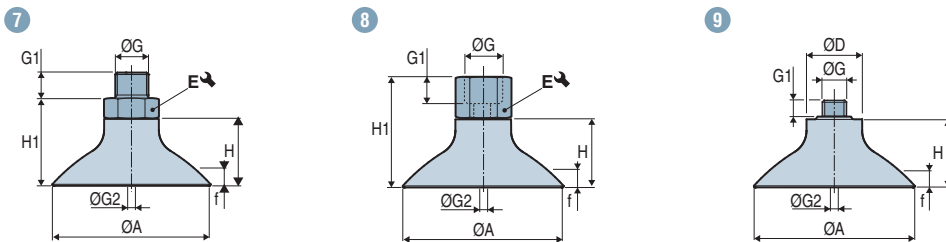

Gruppo 1	Schema	ØA	ØD	f <sup>(1)</sup>	H	H1	ØG	G1	ØG2 <sup>(2)</sup>	E ↻	g (g)	
Ø 8 - 25 mm	VP8---IMM5C	1	7.5	-	1.3	10	15	M5-M	4.5	2.5	7	3.5
	VP8---IMM6C	1	7.5	-	1.3	10	15	M6-M	5	3.5	7	3.1
	VP8---IM18C	1	7.5	-	1.3	10	16	G1/8"-M	7.5	3.5	14	4.5
	VP8---IF18C	2	7.5	-	1.3	10	22	G1/8"-F	8	3.5	14	4.4
	VP10---IMM5C	1	10	-	1.5	10.5	15.5	M5-M	4.5	2.5	7	3.6
	VP10---IMM6C	1	10	-	1.5	10.5	15.5	M6-M	5	3.5	7	3.2
	VP10---IM18C	1	10	-	1.5	10.5	16.5	G1/8"-M	7.5	3.5	14	4.6
	VP10---IF18C	2	10	-	1.5	10.5	22.5	G1/8"-F	8	3.5	14	4.5
	VP15---IMM5C	3	15	-	2.25	11	16	M5-M	4.5	2.5	7	3.8
	VP15---IMM6C	3	15	-	2.25	11	16	M6-M	5	3.5	7	3.4
	VP15---IM18C	3	15	-	2.25	11	17	G1/8"-M	7.5	3.5	14	4.8
	VP15---IF18C	4	15	-	2.25	11	23	G1/8"-F	8	3.5	14	4.7
	VP20---IMM5C	3	20	-	3	11.5	16.5	M5-M	4.5	2.5	7	4.2
	VP20---IMM6C	3	20	-	3	11.5	16.5	M6-M	5	3.5	7	3.8
	VP20---IM18C	3	20	-	3	11.5	17.5	G1/8"-M	7.5	3.5	14	5.2
	VP20---IF18C	4	20	-	3	11.5	23.5	G1/8"-F	8	3.5	14	5.1
	VP25---IMM5C	3	25	-	3	12	17	M5-M	4.5	2.5	7	4.6
	VP25---IMM6C	3	25	-	3	12	17	M6-M	5	3.5	7	4.2
	VP25---IM18C	3	25	-	3	12	18	G1/8"-M	7.5	3.5	14	5.6
	VP25---IF18C	4	25	-	3	12	24	G1/8"-F	8	3.5	14	5.5

Nota: tutte le dimensioni sono indicate in mm

(1) f = Corsa di collasso della ventosa.

(2) Ø G2 = Ø interno dell'inserto.

# VP

## Ventose a coppa Ø da 8 a 75 mm

Dimensioni « ventosa + inserto »



Gruppo 2	Schema	ØA	ØD	f <sup>(1)</sup>	H	H1	ØG	G1	ØG2 <sup>(2)</sup>	E ↘	 (g)	
Ø 26 - 60 mm	VP26---IM18V	5	26	-	3	19.5	24	G1/8"-M	6	3.5	13	17.9
	VP26---IF18V	6	26	-	3	19.5	32.5	G1/8"-F	7.5	3.5	13	21.2
	VP26---IM14	5	26	-	3	19.5	23.5	G1/4"-M	11	4.4	17	11.6
	VP26---IM14C	5	26	-	3	19.5	27.5	G1/4"-M	10	7	17	12.5
	VP26---IM14V	5	26	-	3	19.5	24.5	G1/4"-M	8	3.5	17	27.2
	VP26---IF14	6	26	-	3	19.5	34.5	G1/4"-F	10	4.4	17	12.2
	VP26---IF14C	6	26	-	3	19.5	34.5	G1/4"-F	12	6.9	17	11.8
	VP26---IF14V	6	26	-	3	19.5	35.5	G1/4"-F	11	3.5	17	31.8
	VP30---IM18V	5	30	-	2.5	19	23.5	G1/8"-M	6	3.5	13	17.3
	VP30---IF18V	6	30	-	2.5	19	32	G1/8"-F	7.5	3.5	13	21.6
	VP30---IM14	5	30	-	2.5	19	23	G1/4"-M	11	4.4	17	12.0
	VP30---IM14C	5	30	-	2.5	19	27	G1/4"-M	10	7	17	12.9
	VP30---IM14V	5	30	-	2.5	19	24	G1/4"-M	8	3.5	17	27.6
	VP30---IF14	6	30	-	2.5	19	34	G1/4"-F	10	4.4	17	12.6
	VP30---IF14C	6	30	-	2.5	19	34	G1/4"-F	12	6.9	17	12.2
	VP30---IF14V	6	30	-	2.5	19	35	G1/4"-F	11	3.5	17	32.2
	VP35---IM18V	5	35	-	3	20	24.5	G1/8"-M	6	3.5	13	20.1
	VP35---IF18V	6	35	-	3	20	33	G1/8"-F	7.5	3.5	13	23.4
	VP35---IM14	5	35	-	3	20	24	G1/4"-M	11	4.4	17	13.8
	VP35---IM14C	5	35	-	3	20	28	G1/4"-M	10	7	17	14.7
	VP35---IM14V	5	35	-	3	20	25	G1/4"-M	8	3.5	17	29.4
	VP35---IF14	6	35	-	3	20	35	G1/4"-F	10	4.4	17	14.4
	VP35---IF14C	6	35	-	3	20	35	G1/4"-F	12	6.9	17	14.0
	VP35---IF14V	6	35	-	3	20	36	G1/4"-F	11	3.5	17	34.0
	VP40---IM18V	5	40	-	3	20	24.5	G1/8"-M	6	3.5	13	20.6
	VP40---IF18V	6	40	-	3	20	33	G1/8"-F	7.5	3.5	13	23.9
	VP40---IM14	5	40	-	3	20	24	G1/4"-M	11	4.4	17	14.3
	VP40---IM14C	5	40	-	3	20	28	G1/4"-M	10	7	17	15.2
	VP40---IM14V	5	40	-	3	20	25	G1/4"-M	8	3.5	17	29.9
	VP40---IF14	6	40	-	3	20	35	G1/4"-F	10	4.4	17	14.9
	VP40---IF14C	6	40	-	3	20	35	G1/4"-F	12	6.9	17	14.5
	VP40---IF14V	6	40	-	3	20	36	G1/4"-F	11	3.5	17	34.5
	VP50---IM18V	5	52	-	4.5	22	26.5	G1/8"-M	6	3.5	13	26.4
	VP50---IF18V	6	52	-	4.5	22	35	G1/8"-F	7.5	3.5	13	29.7
	VP50---IM14	5	52	-	4.5	22	26	G1/4"-M	11	4.4	17	20.1
	VP50---IM14C	5	52	-	4.5	22	30	G1/4"-M	10	7	17	21.0
VP50---IM14V	5	52	-	4.5	22	27	G1/4"-M	8	3.5	17	35.7	
VP50---IF14	6	52	-	4.5	22	37	G1/4"-F	10	4.4	17	20.7	
VP50---IF14C	6	52	-	4.5	22	37	G1/4"-F	12	6.9	17	20.3	
VP50---IF14V	6	52	-	4.5	22	38	G1/4"-F	11	3.5	17	40.3	
VP60---IM18V	5	60	-	4.5	22	26.5	G1/8"-M	6	3.5	13	30.1	
VP60---IF18V	6	60	-	4.5	22	35	G1/8"-F	7.5	3.5	13	33.4	
VP60---IM14	5	60	-	4.5	22	26	G1/4"-M	11	4.4	17	23.8	
VP60---IM14C	5	60	-	4.5	22	30	G1/4"-M	10	7	17	24.7	
VP60---IM14V	5	60	-	4.5	22	27	G1/4"-M	8	3.5	17	39.4	
VP60---IF14	6	60	-	4.5	22	37	G1/4"-F	10	4.4	17	24.4	
VP60---IF14C	6	60	-	4.5	22	37	G1/4"-F	12	6.9	17	24.0	
VP60---IF14V	6	60	-	4.5	22	38	G1/4"-F	11	3.5	17	44.0	

### Gruppo 3

Ø 75 mm	VP75---IM18V	9	75	23	4.5	32	-	G1/8"-M	8	6	-	58.3
	VP75---IM14	7	75	-	4.5	32	38	G1/4"-M	11	8	21	46.4
	VP75---IM14V	7	75	-	4.5	32	37	G1/4"-M	8	6	17	68.9
	VP75---IF14	8	75	-	4.5	32	47	G1/4"-F	10	8	21	50.3
	VP75---IF14V	8	75	-	4.5	32	51	G1/4"-F	9	6	17	78.5
	VP75---IM38	7	75	-	4.5	32	43	G3/8"-M	11	8	21	47

Nota: tutte le dimensioni sono indicate in mm

(1) f = Corsa di collasso della ventosa.

(2) Ø G2 = Ø interno dell'inserto.

2  
VP

# VP

## Ventose a coppa Ø da 8 a 75 mm

### Schemi di montaggio



2  
VP

#### VP 8 - 25 Gruppo 1

Raccordi a resca **C**

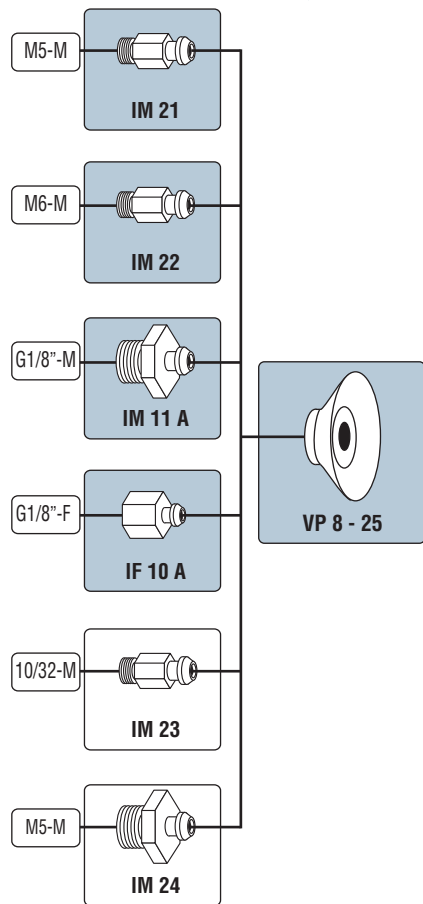

#### VP 26 - 60 Gruppo 2

Raccordi a resca **C**

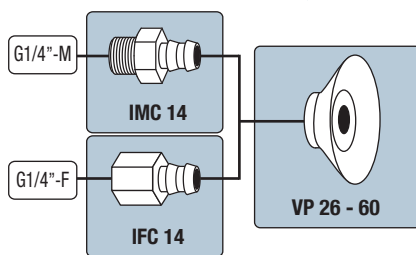

Inserto montato **E**

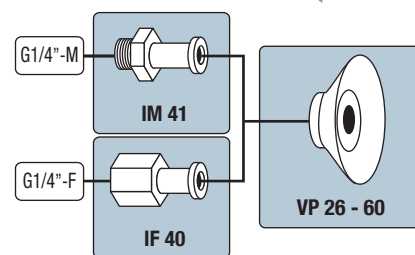

Adattatori

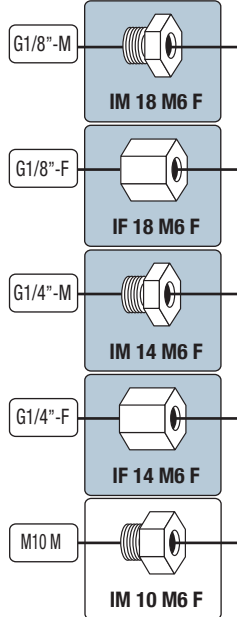

Inserto smontabile **V**

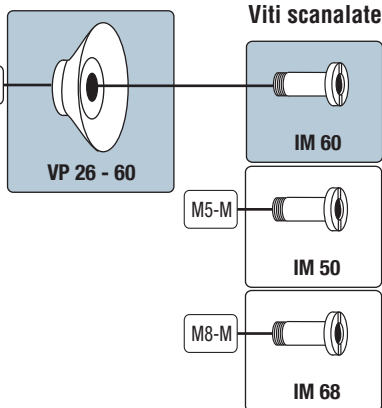

#### VP 75 Gruppo 3

Inserto rivettato in fabbrica **S**

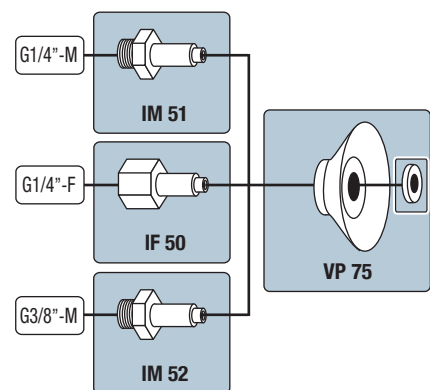

Inserto smontabile **V**

Adattatori

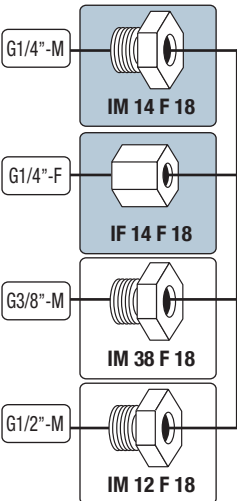

Viti scanalate

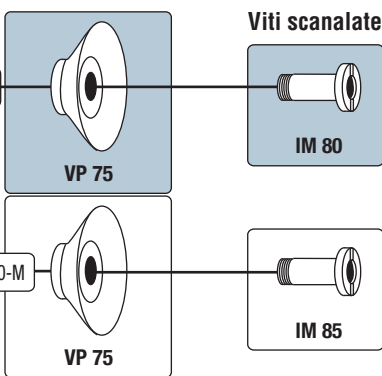

- Configurazioni «ventosa + inserto» rif. Pag. 2/4
- Configurazioni non standard devono essere ordinate con codici separati

Dimensioni d'ingombro degli inserti e ventosa: vedere pagina 2/8.



#### Ventose

VP 8... 10

VP 15... 25

VP 26... 75

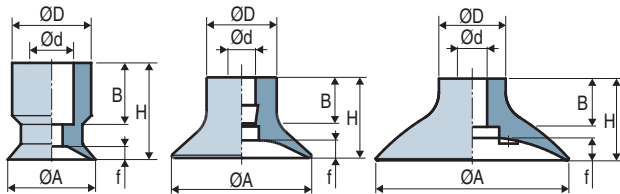

(1) f = Corsa di collasso della ventosa.

	ØA	H	Ød	ØD	f <sup>(1)</sup>	B	⊃ (g)
VP 8	7.5	10	5	9	1.3	7	0.4
VP 10	10	10.5	4.4	9	1.5	7	0.5
VP 15	15	11	4	9	2.25	7	0.7
VP 20	20	11.5	4	10	3	7	1.2
VP 25	25	12	4	10	3	7	1.4
VP 26	26	19.5	8	16	3	13	3.7
VP 30	30	19	8	16	2.5	13	4
VP 35	35	20	8	16	3	13	5.6
VP 40	40	20	8	16	3	13	9
VP 50	52	22	8	18	4.5	13	14
VP 60	60	22	8	18	4.5	13	16
VP 75	75	32	12	23	4.5	20	33

#### Inseri a resca

Maschio - IM

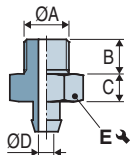

Femmina - IF

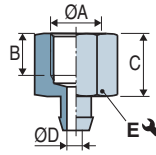

	ØA	B	C	ØD	E	Materiale	⊃ (g)
IM 11 A	G1/8"-M	7.5	6	3.5	14	Alluminio	4.1
IMC 14	G1/4"-M	10	8	7	17	Alluminio	8.7
IM 21 <sup>(2)</sup>	M5-M	4.5	5	2.5	7	Ottone nichelato	3.1
IM 22 <sup>(2)</sup>	M6-M	5	5	3.5	7	Ottone nichelato	2.7
IM 23	10/32-M	4.5	5	2.5	7	Ottone	3
IM 24	M5-M	4.5	2.5	2.5	10	Ottone nichelato	3.2
IF 10 A	G1/8"-F	8	12	3.5	14	Alluminio	4
IFC 14	G1/4"-F	12	15	6.9	17	Alluminio	8

#### Adattatori per viti scanalate

Maschio - IM

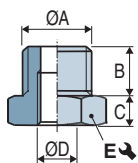

Femmina - IF

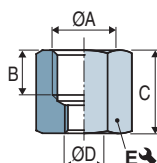

	ØA	B	C	ØD	E	Materiale	⊃ (g)
IM 10 M6F	M10-M	7	3.5	M6-F	13	Ottone	5.9
IM 12 F18	G1/2"-M	14	6	G1/8"-F	22	Ottone nichelato	46.8
IM 14 M6F	G1/4"-M	8	5	M6-F	17	Ottone nichelato	15.9
IM 14 F18	G1/4"-M	8	5	G1/8"-F	17	Ottone nichelato	10.6
IM 18 M6F	G1/8"-M	6	4.5	M6-F	13	Ottone nichelato	6.6
IM 38 F18	G3/8"-M	9	5	G1/8"-F	19	Ottone nichelato	18.8
IF 14 M6F	G1/4"-F	11	16	M6-F	17	Ottone nichelato	20.5
IF 18 M6F	G1/8"-F	7.5	13	M6-F	13	Ottone nichelato	9.9
IF 14 F18	G1/4"-F	9	19	G1/8"-F	17	Ottone nichelato	20.2

I valori sono indicativi delle caratteristiche medie dei prodotti COVAL.

Nota: tutte le dimensioni sono indicate in mm.

(2) Inserti con foro calibrato: diametro calibrato per diminuire le perdite d'aria in caso di utilizzo di teste di presa con più ventose (vedere pagina 4/10).

(3) Disponibile in inox.

#### Viti scanalate

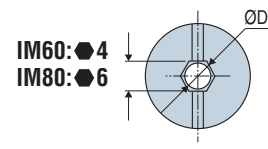
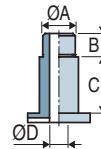

	ØA	B	C	ØD	Materiale	⊃ (g)
IM 50	M5-M	5	11	2.8	Ottone	7.4
IM 60 <sup>(2) (3)</sup>	M6-M	7	11	3.5	Ottone nichelato	7.5
IM 68	M8-M	8	11	5.2	Ottone nichelato	6.4
IM 80	G1/8"-M	8	18	6	Ottone nichelato	23.7
IM 85	M10x150-M	8	18	6	Ottone nichelato	23.5

#### Inserto rivettato in fabbrica

Maschio - IM

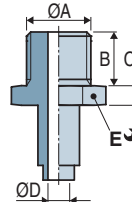

Femmina - IF

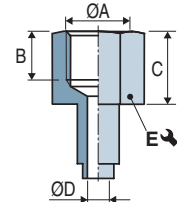

	ØA	B	C	ØD	E	Materiale	⊃ (g)
IM 51	G1/4"-M	11	6	4.4	17	Alluminio	11.8
IF 50	G1/4"-F	10	15	8	21	Alluminio	15.7
IM 52	G3/8"-M	11	6	8	21	Alluminio	14

#### Inserto montato in fabbrica

Maschio - IM

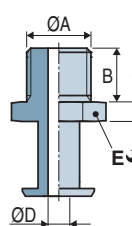

Femmina - IF

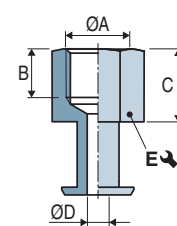

	ØA	B	C	ØD	E	Materiale	⊃ (g)
IM 41	G1/4"-M	11	4	4.4	17	Alluminio	7.8
IF 40	G1/4"-F	10	15	4.4	17	Alluminio	8.4